

-  Dielectric Grease (92-823506-1)
-  Loctite PST Pipe Sealant (92-809622)

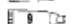
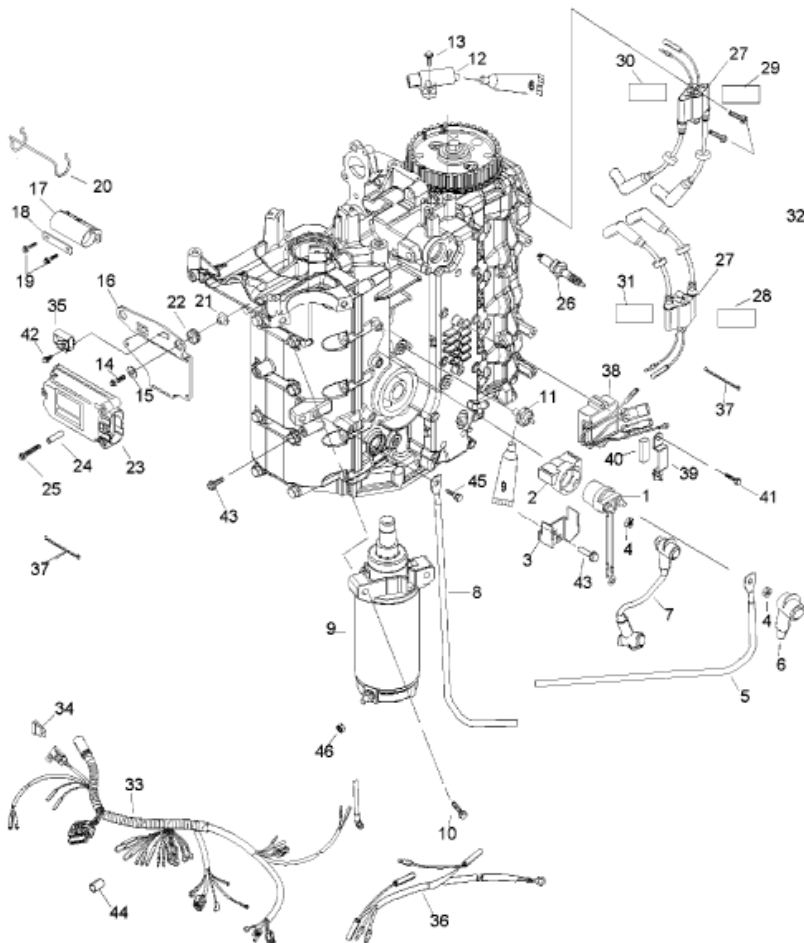

ELECTRICAL COMPONENTS

Parts List						
Ref	Class	Part	Description	Qty	Comment	Footnote
1	89	825096T	SOLENOID	1		
2		95643M	BRACKET	1		
3		825074	SOLENOID PLATE	1		
4	11	40138 6	NUT (M6)	2		
5	84	88439A 9	BATTERY CABLE (POSITIVE)	1		
6	85	880786	BOOT (RED)	1		
7	84	93388A16	CABLE	1		
8	84	88439A 4	BATTERY CABLE (NEGATIVE)	1		
9	50	884044T	STARTER MOTOR (SEE BREAKD	1		
10	10	40011153	SCREW (M8 X 45)	3		
11	87	828040 1	PRESSURE SWITCH	1		5
12		828358	SENSOR-CRANK POSITION	1		
13	10	40011107	SCREW (M5 X 16)	2		
14	10	821300 25	SCREW (M6 X 25)	3		
15	12	40023 16	WASHER	3		
16		859224	PLATE	1		
17		856836	RETAINER	1		
18		856040	BRACKET	1		
19	10	821291 14	SCREW (M6 X 14)	2		
20		92753	RETAINER	1		
21	23	856954	BUSHING	3		
22	25	834985	GROMMET	3		
23		878433A 3	ECM	1		
24	23	853920 1	BUSHING	3		
25	10	821291 40	SCREW (M6 X 40)	3		
26	33	827858	SPARK PLUG (NGK DPR6EA-9)	4		
27	339	859738T 1	IGNITION COIL	2		
28		NSS	DECAL	1	(COIL ID #1)	
29		NSS	DECAL	1	(COIL ID #2)	
30		NSS	DECAL	1	(COIL ID #3)	
31		NSS	DECAL	1	(COIL ID #4)	
32	10	826844 30	SCREW (M6 X 30)	4		
33	84	857111T 2	ENGINE WIRING HARNESS	1		
34	88	812619	FUSE (SFE 20 AMP)	1		
35		828054	COVER	1		
36	84	852375A 6	HARNESS-EXTENSION	1	(HANDLE)	
37	54	816311T	STA-STRAP	AR		
38		883071T 1	VOLTAGE REGULATOR	1		
39		858413	BRACKET	1		
40		830897 1	FOAM PAD	1		
41	10	824822 9	SCREW (M6 X 40)	2		